

## Plant List

KEY	BOTANICAL NAME	COMMON NAME	SIZE	ROOT	QUAN
DECIDUOUS TREES					
AcTF	AMELANCHIER CANADENSIS TREE FORM	TREE FORM SHADBLOW SERVICEBERRY *	60 mm	UB	3
AfJ	ACER FREEHANNI 'JEFFERSRED'	AUTUMN BLAZE MAPLE	70 mm	UB	2
PcA	PYRUS CALLERYANA 'ARISTOCRAT'	ARISTOCRAT FLOWERING PEAR	60 mm	UB	2
SrS	SYRINGA RETICULATA 'IVORY SILK'	IVORY SILK TREE LILAC	60 mm	UB	2
TcG	TILIA CORDATA 'GREENSPIRE'	GREENSPIRE LINDEN	70 mm	UB	2
TREE STANDARDS & SPECIMEN SHRUBS					
Aa	AMELANCHIER ALNIFOLIA	SASKATOON SERVICEBERRY	200 cm	UB	2
ApB	ACER PALMATUM 'BLOODGOOD'	BLOODGOOD JAPANESE MAPLE	200 cm	UB	1
CONIFEROUS TREES					
PpFA	PICEA FUNGENS 'FAT ALBERT'	FAT ALBERT BLUE SPRUCE	175 cm	UB	2
DECIDUOUS SHRUBS					
BtRB	BERBERIS THUNBERGI 'ROYAL BURGUNDY'	ROYAL BURGUNDY BARBERRY	30 cm	POT	10
FNG	FORSYTHIA 'NORTHERN GOLD'	NORTHERN GOLD FORSYTHIA	60 cm	POT	4
HnGE	HYDRANGEA MACRO 'GLOWING EMBERS'	GLOWING EMBERS FLORIST HYDRANGEA	50 cm	POT	14
SbAU	SPIRAEA BUMALDA 'ANTHONY WATERER'	ANTHONY WATERER SPIREA	50 cm	POT	12
SbGM	SPIRAEA BUMALDA 'GOLDFOUND'	GOLDFOUND SPIREA	40 cm	POT	11
SmP	SYRINGA MEYERI 'PALIBIN'	PALIBIN DWARF LILAC	50 cm	POT	14
Vc	VIBURNUM CARLEPHALUM	FRAGRANT SNOBALL	60 cm	POT	6
EVERGREENS					
EFC	EUCONYMUS FORTUNEI 'COLORATUS'	PURPLE WINTERCREEPER	40 cm	POT	9
JW	JUNIPERUS HORIZONTALIS 'WILTON'	BLUE RUG JUNIPER	40 cm	POT	23
RFJM	RHODODENDRON 'F.J.M.'	F.J.M. RHODODENDRON	60 cm	POT	1
TnD	TAXUS MEDIA 'DENSIFORMIS'	DENSE YEW	50 cm	POT	22
PERENNIALS & ORNAMENTAL GRASS					
CaKF	CALAMAGROSTIS ACUTIFLORA 'KARL FOERSTER'	KARL FOERSTER FEATHER REED GRASS	2 gal	POT	30
HC	HEUCHERA 'CRIMSON'	CRIMSON CORAL BELLS	2 gal	POT	7
HCF	HEMEROCALLIS 'CHILDREN'S FESTIVAL'	CHILDREN'S FESTIVAL DAYLILY	2 gal	POT	32
HDC	HEMEROCALLIS 'DOUBLE CUTIE'	DOUBLE CUTIE DAYLILY	2 gal	POT	50
BOULDERS					
CLB	CUBICAL LIMESTONE BOULDER		2000 lbs.		1

\*SINGLE STEM TREE.  
NOT MULTI STEM SHRUB

THE CONTRACTOR IS RESPONSIBLE FOR THE COUNT OF THE PLANTS. REPORT ANY DISCREPANCY TO THE LANDSCAPE ARCHITECT. IN THE CASE OF A DISCREPANCY, THE QUANTITY OF PLANTS ON THE LANDSCAPE PLAN SUPERSEDES THE QUANTITY SHOWN IN THE PLANT LIST.

## Legend

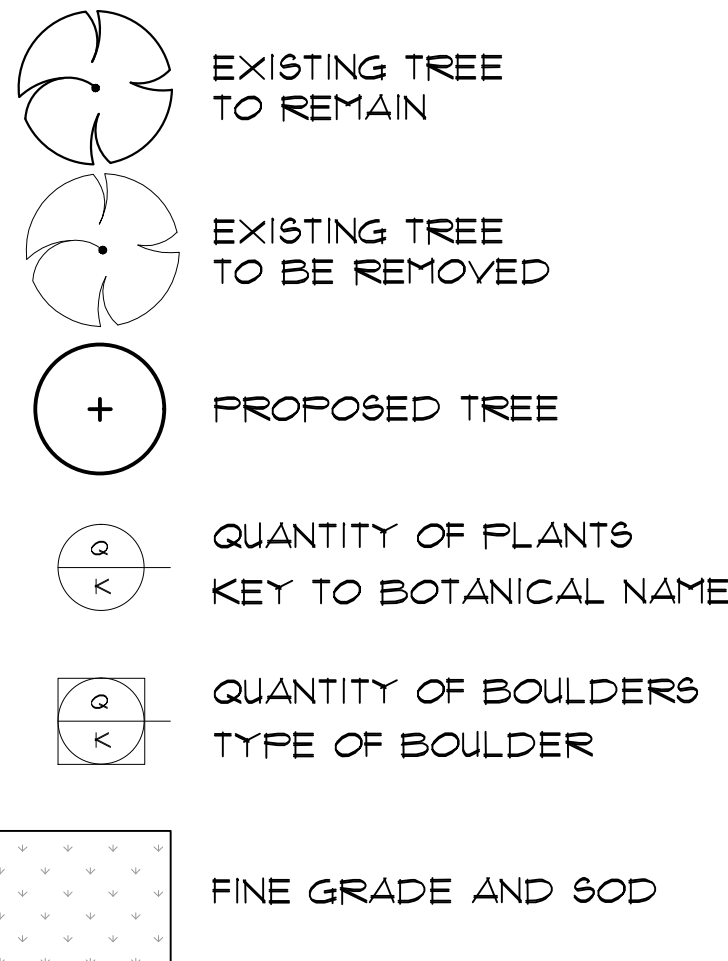

## General Landscape Notes

FINE GRADE ALL AREAS DESIGNATED FOR SEED OR SOD, REMOVING ALL EXISTING VEGETATION, DEBRIS, AND STONES WHETHER IMPORTED OR NATIVE TO THE SITE. SEED OR SOD ALL SITE AREAS AS INDICATED ON THE LANDSCAPE PLAN EXCEPT THOSE WHERE PLANTING BEDS, PAVEMENT OR BUILDINGS ARE INDICATED. EXTEND SOD TO PROPERTY LINES FOR INTERIOR LOT LINES AND TO THE CURB FOR STREET FRONTAGE. APPLY A ROOTING FERTILIZER PRIOR TO INSTALLING SOD OR SEED. RESTORE ANY AREAS OF THIS SITE OR ADJACENT PROPERTIES RESULTING FROM CONSTRUCTION OF THIS PROJECT.

### SOD/SEED ESTABLISHMENT AND PLANTING BED MAINTENANCE:

PROVIDE CARE AND PROTECTION TO ENSURE PROPER AND FULL ESTABLISHMENT OF ALL TURF AREAS. REPAIR ALL BARE AREAS. CARE OF SOD AREAS WILL EXTEND FROM THE TIME OF INSTALLATION TO THE FIRST CUT BY THE CONTRACTOR. AT TIME OF FIRST CUT, REMOVE WEEDS THAT HAVE COME THROUGH THE SOD FROM THE SOIL AND REMOVE ANY WEEDS IN THE PLANTING BEDS (WEED BEDS 30 DAYS AFTER INSTALLATION IF NO SOD HAS BEEN INSTALLED).

SPREAD EXISTING TOPSOIL OVER SMOOTH SUBGRADE IN ORDER TO ACHIEVE A 4" MINIMUM DEPTH FOR ALL TURF AREAS. PROVIDE ADDITIONAL TOPSOIL AS REQUIRED.

ADVISE THE LANDSCAPE ARCHITECT OR PROJECT MANAGER OF THE LOCATION OF THE STOCKPILE AND ALLOW ADEQUATE TIME FOR TESTING PRIOR TO IMPORTING SOIL.

REMOVE ALL DEBRIS FROM AND ENSURE THERE IS FRIABLE TOPSOIL TO A DEPTH OF 18" IN ALL PLANTING BEDS. SUPPLY ADDITIONAL TOPSOIL AS REQUIRED.

INSTALL 3" DEPTH SMALL BEACH FEBBLE IN ALL PLANTING BEDS AND CANADA RED MULCH IN THE ROOT SAUCERS OF TREES. MULCH SHOULD BE 1/2" BELOW THE ADJACENT SURFACE WITHIN 24" OF THE EDGE OF THE BED. INSTALL A WEED CONTROL BARRIER CONSISTING OF LANDSCAPE FABRIC BENEATH THE BEACH FEBBLE.

FOR ALL EXISTING TREES WITHIN THE PROJECT AREA, REMOVE EXISTING TURF IN A CIRCLE AROUND THE BASE OF THE TREE (OR CREATE NEW IF NEW TURF IS BEING ESTABLISHED) AND INSTALL 3" DEPTH OF CANADA RED MULCH. USE THE FOLLOWING GUIDELINES TO DETERMINE THE DIAMETER OF THE TURF TO BE REMOVED AND MULCHED AROUND EXISTING TREES:

TREE DIAMETER	DIAMETER OF CIRCLE TO BE MULCHED
LESS THAN 12"	48"
GREATER THAN 12"	DIAMETER OF TREE PLUS 4'-0"

SUPPLY AND INSTALL COMMERCIAL GRADE POLYEDGER WHERE PLANTING BEDS ARE ADJACENT TO TURF. SECURE EACH 20' LENGTH OF POLYEDGER WITH 6 STEEL PEGS AND JOIN WITH A PLASTIC CONNECTOR.

WHERE EAVES TROUGHS DISCHARGE INTO PLANTING BEDS, SUPPLY AND INSTALL CONCRETE SPLASH BLOCKS. ADJUST PLANTING AS REQUIRED TO ENSURE THAT THE PLANTS WILL NOT BE IN LINE WITH THE WATER DISCHARGED FROM THE DOWN SPOUTS.

GUARANTEE ALL PLANT MATERIAL FOR A PERIOD OF ONE YEAR FROM ACCEPTANCE. REPLACE ALL DEAD OR WEAK PLANT MATERIAL PROMPTLY WHEN DIRECTED BY THE OWNER OR PROJECT MANAGER. GUARANTEE REPLACEMENT PLANT MATERIAL FOR A PERIOD OF ONE YEAR FROM PLANTING. PLANTS DAMAGED DUE TO VANDALISM ARE NOT GUARANTEED.

VERIFY QUANTITIES OF PLANTS INDICATED IN THE PLANT KEYS AND PLANT LIST WITH THOSE SHOWN ON THE PLAN.

NOTIFY THE LANDSCAPE ARCHITECT OF ANY DISCREPANCIES PRIOR TO TENDERING.

ALL WORK TO BE PERFORMED IN COMPLIANCE WITH THE HEALTH AND SAFETY ACT 1980, ONTARIO Reg. 213/91, 114/82 AND LATEST REVISIONS.

DETERMINE AND VERIFY THE LOCATION AND EXISTENCE OF ALL UNDERGROUND UTILITIES PRIOR TO COMMENCING CONSTRUCTION.

ADVISE THE LANDSCAPE ARCHITECT OF ANY CONFLICT BETWEEN THE PROPOSED WORK AND EXISTING UTILITIES.

REPAIR ANY AND ALL DAMAGE DONE TO THIS SITE OR ADJACENT SITES RESULTING FROM CONSTRUCTION OF THIS PROJECT.

VERIFY THAT ALL EXISTING SITE CONDITIONS ARE AS SHOWN ON THIS PLAN.

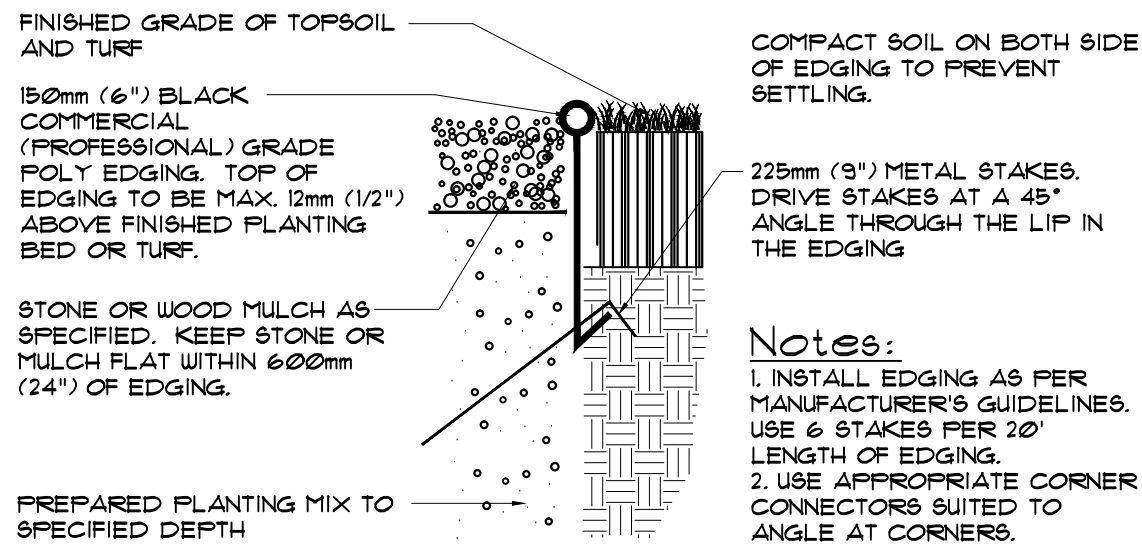

## Poly Edging Installation

NTS

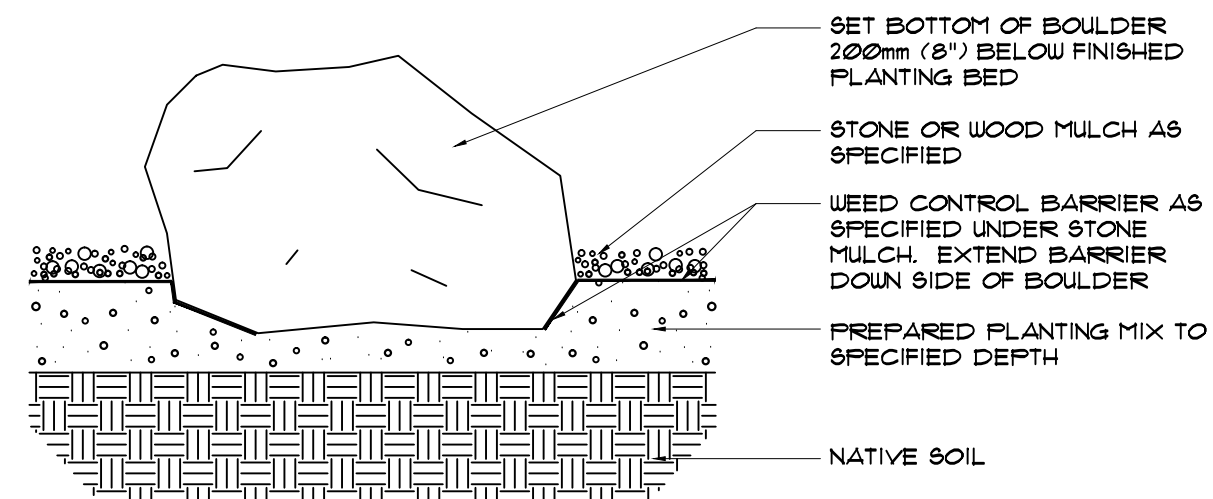

## Boulder Installation

NTS

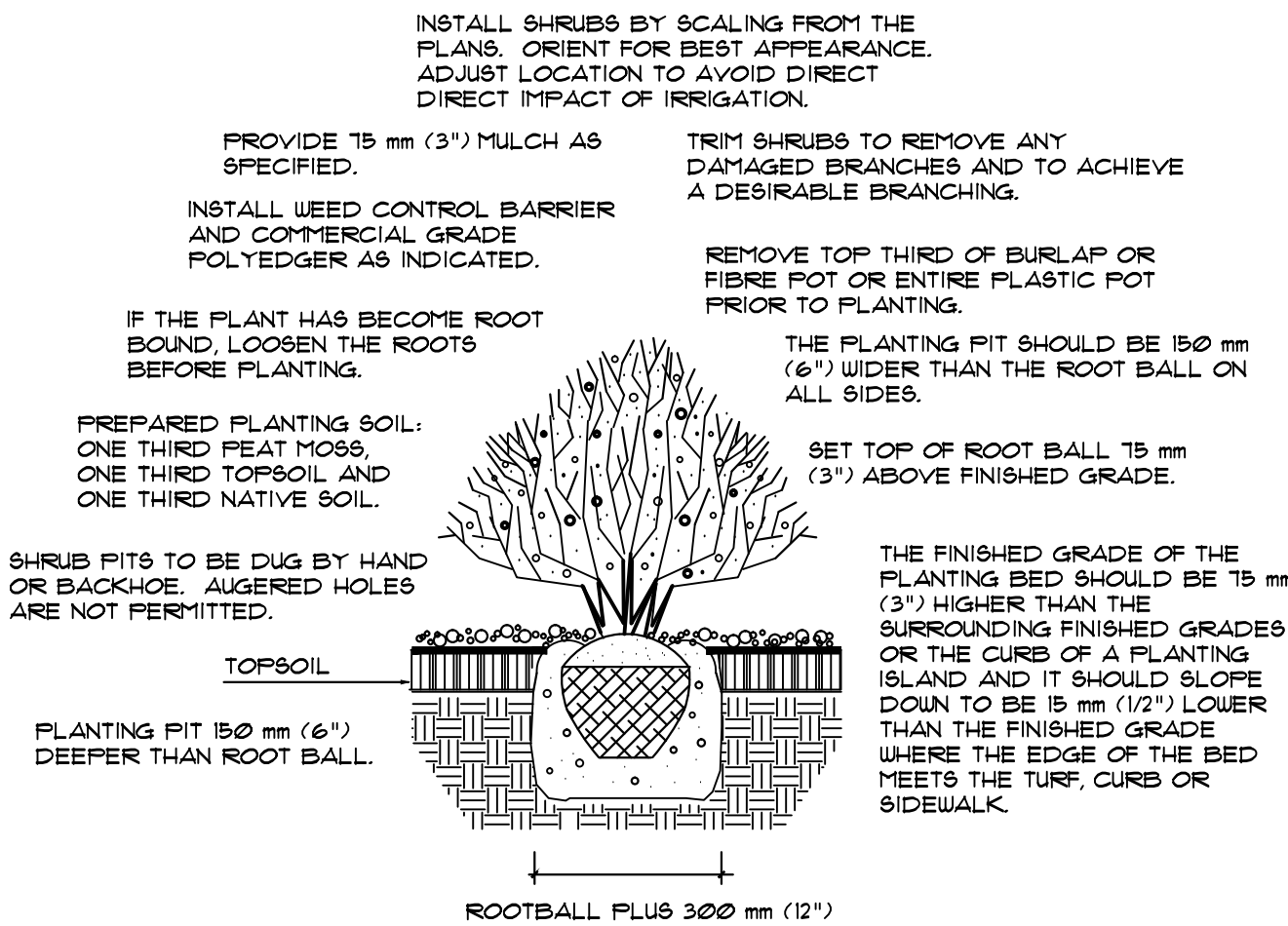

## Shrub Planting

NTS

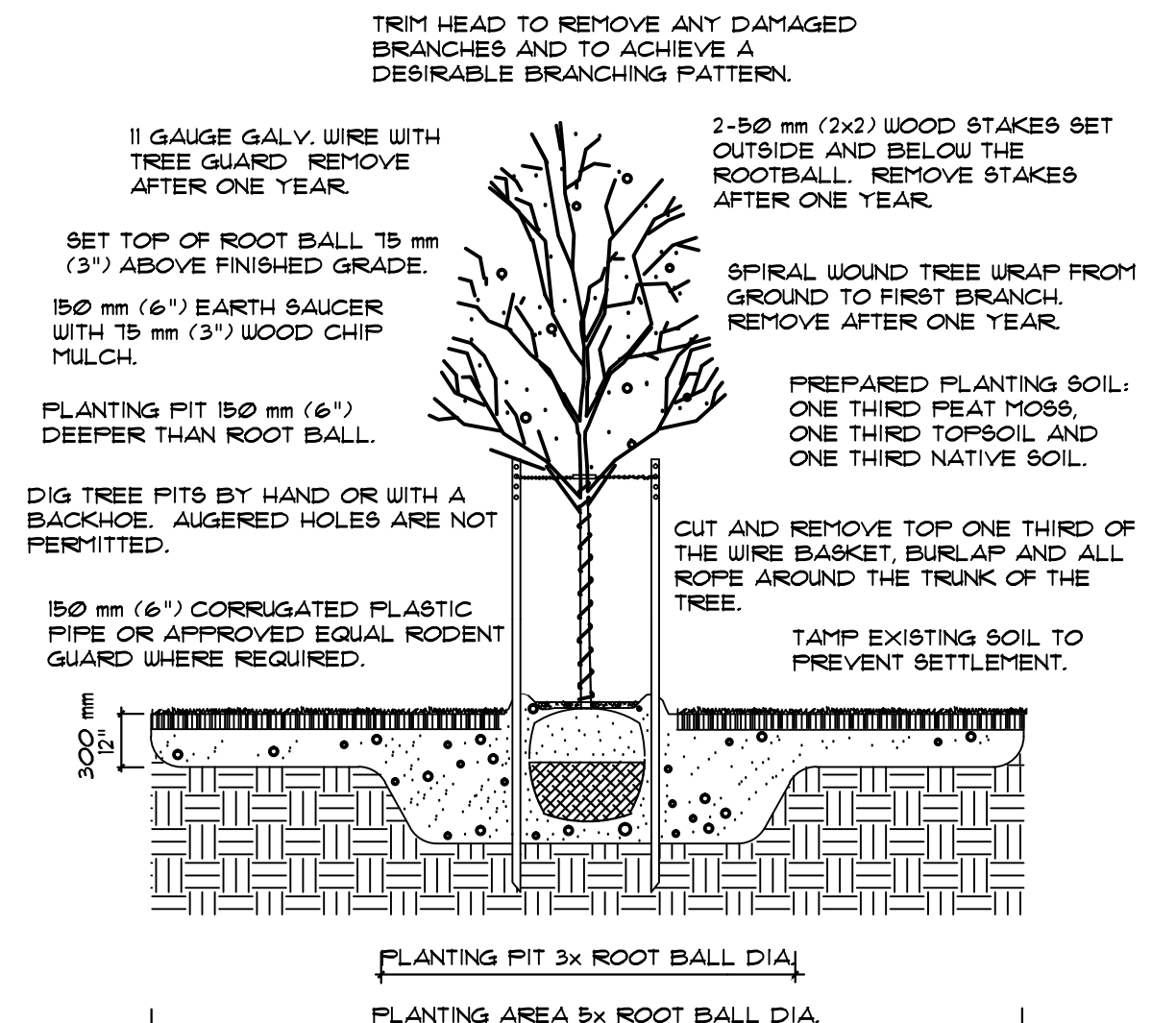

## Deciduous Tree Planting

NTS

## LANDSCAPE PLAN

SCALE 1" = 20'-0"

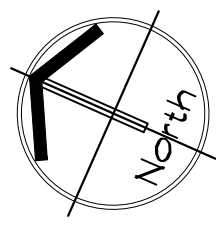
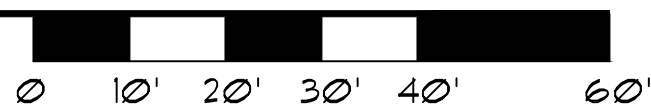

BP

Bezaire Partners

Planners, Landscape Architects,  
Mediation, Public Consultation,  
Project Management

302-180 Eugene St. West  
Windsor, ON N8X 2X6  
p: 519 966 6844

gbezaire@bezaire.ca

SEAL:

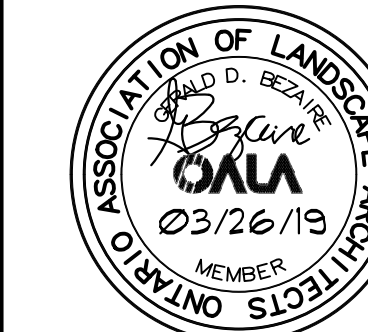

ISSUED:

REVISIONS:

All drawings, specifications and other related documents are the copyright property of the CONSULTANT and shall be returned upon request. Reproduction of drawings and related documents, in whole or in part, is forbidden without the written permission of the CONSULTANT. The contractor shall check and verify all pertinent dimensions and report any discrepancies to the CONSULTANT before proceeding with the work.

PROJECT:

PROPOSED 3  
STOREY, 15 UNIT  
CONDOMINIUM  
DEVELOPMENT

FOR  
THE FAIRVIEW  
INC.  
480 FAIRVIEW BLVD.  
WINDSOR, ONTARIO

DRAWING TITLE:

LANDSCAPE  
PLAN AND  
DETAILS

SCALE:

As Noted

DRAWN BY:

GDB

CHECKED BY:

FLB

APPROVED BY:

DATE:

MARCH, 2019

DRAWING NO:

LA-1

CAD file: 1202 lnds R3